

HCT | Fragrance

CATALOG

CONFIDENTIALITY AGREEMENT

The Presentation contained on the following pages are confidential and proprietary information owned exclusively by HCT Packaging, Inc. or one of its affiliates ("HCT").

By viewing the Presentation, you are acknowledging and agreeing, on behalf of yourself and any third parties you represent, to hold in strict confidence any and all information and materials provided to you by HCT in connection with the Presentation, whether disclosed orally or in writing ("HCT Information"). You further agree that you will not use, disclose or otherwise exploit the HCT information without HCT's express written consent. In the event of any breach by you or your agents of the promises contained in this paragraph, HCT intends to vigorously enforce its rights with respect to the HCT information by pursuing all legal and equitable remedies available to it, including seeking the imposition of sanctions.

TABLE OF CONTENTS

> **HCT FRAGRANCE INTRODUCTION**

> **SCENT DEVELOPMENT**

> **CAPABILITIES**

> **ATOMIZERS**

> **GLASS BOTTLES**

> **CAPS**

> **SOLIDS**

> **NEW FORMATS**



HCT FRAGRANCE

HCT's Fragrance division focuses on fragrance with a purpose – delivering products that stretch beyond just smelling nice, to elevate everyday moments in holistic and meaningful ways, through innovative sensorial experiences.

As part of the most outstanding network of labs and manufacturers in Asia, Europe, and North America, clients are guided through the complete development process, and offered full turnkey solutions that meet the specific needs of their brands. Partnering with the world's best fragrance houses, HCT utilizes the latest generation of raw materials, delivering formulations that are customizable and uniquely designed, applying cutting-edge technologies that far surpass industry standards.

HCT'S FULL-SERVICE, END-TO-END, TURNKEY SOLUTIONS TAKE BEAUTY BRANDS TO THE NEXT LEVEL.

> **IN-HOUSE CREATIVE TEAM**

Industrial Design
Graphic Design
Engineering
Prototyping

> **IN-HOUSE MANUFACTURING**

3 Plastic injection molding factories
3 Fill and assembly factories
1 Metal injection molding factory
1 Electroplating factory
1 Airless systems factory
1 Brush factory
1 Bulk manufacturing facility

> **CUSTOM BEAUTY TOOLS, ACCESSORIES & DEVICES**

Synthetic, natural, and silicone brushes	Beauty tools
Applicators	Skincare tools
Cut & Sew Bags	Haircare tools
Homecare devices	
Candles	
Mirrors	

> **GLOBAL FOOTPRINT**

> **FORMULATION R&D**

> **WORLD'S LARGEST STOCK CATALOG**

> **CUSTOM BRAND STRATEGY**

> **CUSTOM TOOLING AND MOLDS**

> **WHITE SPACE IDENTIFICATION & TREND FORECASTING**

> **REGULATORY ASSISTANCE & PATENT ENFORCEMENT**

> **COMPATIBILITY & STABILITY TESTING**

> **QUALITY CONTROL**

> **CUSTOMS & CLEARANCE**

> **SHIPPING & LOGISTICS**



INTRODUCTION



SCENT DEVELOPMENT

HCT Fragrance works with clients from concept to completion to develop a unique signature scent or flavor that captures the true essence of the brand. The right ingredient palette will inject life, beauty, and complexity into a product.

Utilizing HCT's creative expertise, design innovation, and passionate product development teams provide brands with the perfect partner to bring new products to life through fragrance. We understand what's needed at each application, from liquids and gels, to candles, aerosols, and more!

- > **GLOBAL SUSTAINABLE INGREDIENT SOURCING**
- > **SCENT EVALUATION**
- > **MARKET INSIGHTS**
- > **PACKAGING INNOVATION**



CROSS-CATEGORY CAPABILITIES

> BEAUTY & PERSONAL CARE

- Body care
- Color cosmetics
- Fine Fragrance
- Haircare
- Skincare

> HOME CARE

- Aerosols
- Candles
- Diffusers
- Mists
- Plugins



GLASS BOTTLES



GLASS BOTTLE

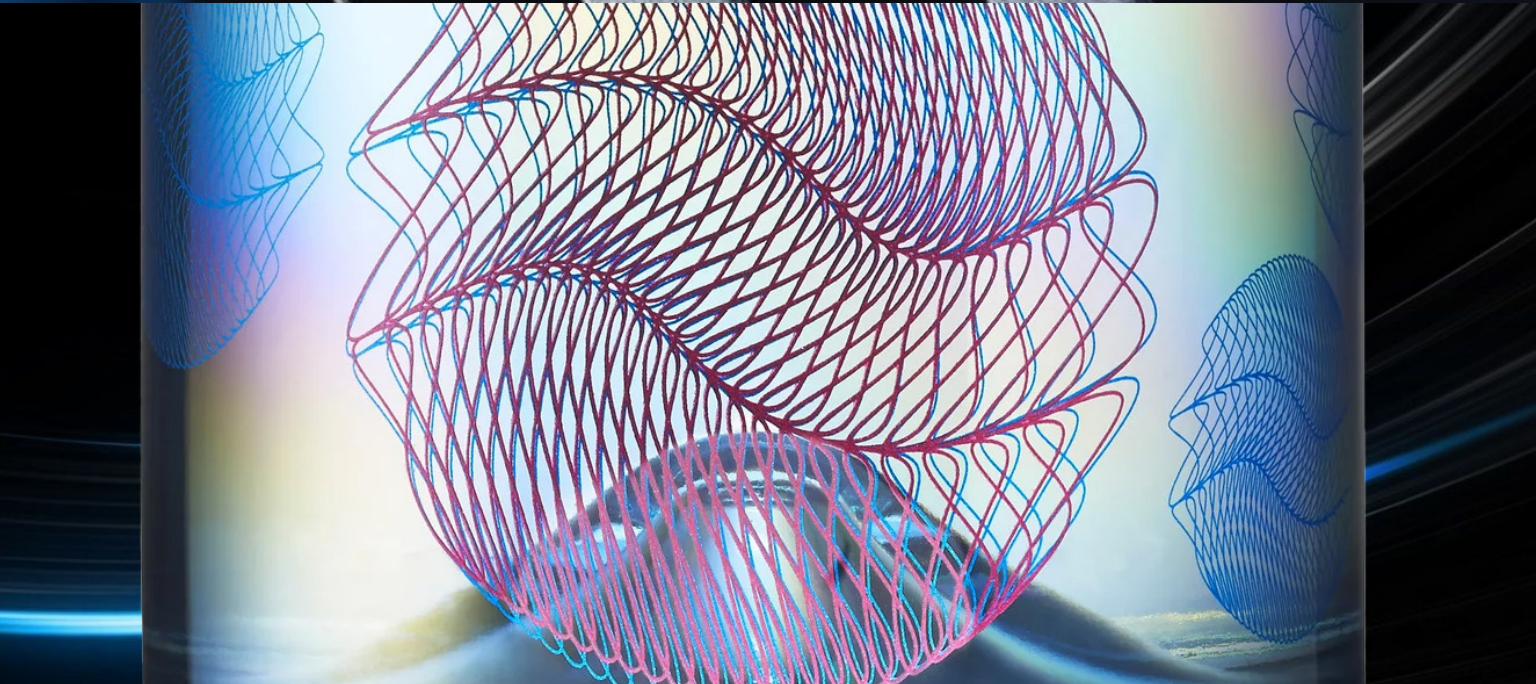

THE DECORATION OF GLASS

> SCREEN PRINTING

This popular decoration process utilizes heat to transfer inks onto glass surfaces, achieving vivid and durable graphics of varying complexity and colors. One of its main advantages is that it is a more environmentally friendly process and allows the glass to maintain its recyclability.



> HOT STAMPING

Same process as on plastic packaging, Hot stamping transfers a metal foil onto an object without creating any problems to the coating. It produces a luxe appearance and brings added value to the bottle. It is available in gold, silver, and other metallic colors with the option for glossy, satin, matte, or iridescent finishes.



> LABELING

Simple and cost-effective decoration that involves sticking adhesive labels to the glass surface, providing flexible and affordable decoration for glass bottles. There are endless design options, including different materials, shapes, sizes, colors, and finishes that are available with this technique.



> FROSTING

Frosting is a method of decorating glass bottles that requires etching or sandblasting the glass surface to produce a matte or frosted look. This process gives the glass bottle a delicate, velvety feel that gives it a dash of class and finesse. Frosting is frequently employed to produce a subdued and unobtrusive branding or design accent that enhances the overall attractiveness of the packaging. It offers a variety of design options and can be applied to specific areas, or the complete glass bottle.



> DEBOSSING/EMBOSSING

The classic techniques of debossing and embossing on glass add dimension, personalization, and a touch of elegance and sophistication. The process etches precise relief and depth into the glass mold, resulting in a unique and dimensional design. Debossing/Embossing decoration is not only cost effective but also highly durable.



> ZAMAC PLAQUE

Adding a ZAMAC plaque or applique to your bottle will add an extra layer of luxe to the package. Luxury fine fragrance bottles often have a metal accent added to the bottle to express a high-end designer aesthetic.



> SPRAY COATING

This technique entails coating the bottle's surface with a barrier made of paint, lacquer, or enamel. Spray coating is a common technique to create elaborate motifs and patterns for eye-catching effect on glass bottles.



> GRADIENT

A popular decorative element seen with glass bottles is often the use of a color gradient. The ombre effect on the glass is a great way to express a colorful brand aesthetic. Color can be obtained in different ways, such as adding different minerals and elements to clear molten glass, or internal and external sandblasting.



> ACCESSORY

Adding an accessory to your package provides an additional branding element to the final product. Details like a wax seal, a metallic medallion, a crafted glass accessory, a leather or fabric piece, or even a jewel can really bring the product to life. The possibilities are endless.





FRAGRANCE CAPS

A unique cap is the fragrance bottle's crown. The cap is a key part of perfume packaging, where the design structure of the bottle cap not only affects the shelf life of the product, but also defines the overall aesthetic of the packaging.

The most used bottle cap materials on the market are ZAMAC, ABS, acrylic, surlyn, and wood. To prevent the perfume from corroding, an inner cap in plastic material like PP is added to fragrance lids except for the Surlyn cap.

> ZAMAC

ZAMAC caps, one of the most popular cap choices for prestige and niche brands, is the perfect combination of stability, ductility, strength, and luxe finish characteristics. This luxurious material of alloy zinc boosts a heavy metal texture and the natural cooling effect upon touching it creates a sensorial experience.



> ALUMINUM

Aluminum cap is a more economical alternative to heavy weight zamac caps, yet still offers the premium metal finish, high coating efficiency and versatility in colors.



> SURLYN

Unlike other plastic bottle caps, Surlyn fragrance caps are more special. It is made of Surlyn resin, which has excellent abrasion, scratch, and corrosion resistance. A plastic inner cap is usually not required for surlyn caps.



> WOOD

Wooden caps are loved by fragrance brands with sustainability in mind. The material embodies a natural color and texture that communicates an earthy aesthetic. One of the great advantages that wood caps have over other materials, is that they can be customized without high tooling costs.



> NATURAL CORK

A revolutionary material consisting of a synthetic rubber-blend mixed with ground pieces of natural cork. For the first time a micro-agglomerated natural cork is injection molded and formed without using glue. This new material uses less petroleum-based materials, while giving the component a natural look and feel. The natural look, the soft-touch surface, and the general cork characteristic, enhance the user experience.



> NEW MATERIAL

HCT Fragrance is constantly on the lookout for new innovative, and sustainable material for fragrance caps.



P23 / P22 / P21 / P20

CYLINDRICAL - CHUNKY

- > NECK SIZE
FEA 13
FEA 15
FEA 18
FEA 20
- > NECK FINISH
Crimp
Screw
- > FILL
P23: 100ml
P22: 100ml
P21: 50ml
P20: 50ml
- > DIMENSION
P23: Ø-53mm x H-99mm
P22: Ø-60.5mm x H-83.8mm
P21: Ø-49.7mm x H-71.6mm
P20: Ø-51.5mm x H-59.7mm



P25 / P19 / P18 / P16

CYLINDRICAL - CHUBBY

- > NECK SIZE
FEA 13
FEA 15
FEA 18
FEA 20
- > NECK FINISH
Crimp
Screw
- > FILL
P25: 100ml
P19: 50ml
P18: 30ml
P16: 30ml
- > DIMENSION
P25: Ø-51.5mm x H-103mm
P19: Ø-41.1mm x H-78.9mm
P18: Ø-39mm x H-68mm
P16: Ø-37.5mm x H-70mm



P24 / P17

CYLINDRICAL - SLIM

- > NECK SIZE
FEA 13
FEA 15
FEA 18
FEA 20
- > NECK FINISH
Crimp
Screw
- > FILL
P24: 100ml
P17: 30ml
- > DIMENSION
P24: Ø-39.8mm x H-159mm
P17: Ø-33.2mm x H-98mm



XD757/410

RECTANGULAR - SHORT

> NECK SIZE

FEA 13
FEA 15
FEA 18
FEA 20

> NECK FINISH

Crimp
Screw

> FILL

P7: 50ml
P1: 30ml

> DIMENSION

P7: H-60mm x W-54mm x D-36mm
P1: H-78mm x W-50.4mm x D-24.5mm



P12 / P6 / P4

RECTANGULAR - MEDIUM

> NECK SIZE

FEA 13
FEA 15
FEA 18
FEA 20

> NECK FINISH

Crimp
Screw

> FILL

P12: 100ml
P6: 50ml
P4-12: 50ml

> DIMENSION

P12: H-98.4mm x W-70mm x D-37mm
P6: H-95mm x W-60mm x D-25.6mm
P4: H-86.7mm x W-60mm x D-27mm



P14 / P15 / P3

RECTANGULAR - TALL

> NECK SIZE

FEA 13
FEA 15
FEA 18
FEA 20

> NECK FINISH

Crimp
Screw

> FILL

P14: 100ml
P15: 100ml
P3: 50ml

> DIMENSION

P14: H-118mm x W-75mm x D-29mm
P15: H-110mm x W-72mm x D-30mm
P3: H-103mm x W-63mm x D-26.7mm



P11 / P15

CUBOIDAL - SHORT

- > NECK SIZE
FEA 13
FEA 15
FEA 18
FEA 20
- > NECK FINISH
Crimp
Screw
- > FILL
P11: 100ml
P5: 50ml
- > DIMENSION
P11: H-74mm x W-43mm x D-31.6mm
P5: H-60mm x W-72.3mm x D-52mm



P8 / P9 / P2

CUBOIDAL - MEDIUM

- > NECK SIZE
FEA 13
FEA 15
FEA 18
FEA 20
- > NECK FINISH
Crimp
Screw
- > FILL
P8: 50ml
P9: 50ml
P2: 30ml
- > DIMENSION
P8: H-88.8mm x W-74.8mm x D-53.5mm
P9: H-85mm x W-52mm x D-38mm
P2: H-83mm x W-54mm x D-40mm



P13 / P10

CUBOIDAL - TALL

- > NECK SIZE
FEA 13
FEA 15
FEA 18
FEA 20
- > NECK FINISH
Crimp
Screw
- > FILL
P13: 100ml
P10: 100ml
- > DIMENSION
P13: H-109mm x W-45.2mm x D-45.2mm
P10: H-110mm x W-72mm x D-30mm



HD10178

APRIL

> NECK SIZE
FEA 15

> NECK FINISH
Crimp

> FILL
50ml

> DIMENSION
H-60.7mm x W-76mm x D-36mm

HD13467/13468

AUREA

> NECK SIZE
FEA 15

> NECK FINISH
Crimp

> FILL
50ml
100ml

> DIMENSION
H-84.2mm x W-42mm x D-36mm
H-112.2mm x W-49mm x D-42mm

F7079/7080

ABSOLU

> NECK SIZE
FEA 15

> NECK FINISH
Crimp

> FILL
50ml
100ml

> DIMENSION
H-102mm x W-59.2mm x D-22.4mm
H-124.4mm x W-72.2mm x D-27.2mm



F7008/7009

CHARM

> NECK SIZE
FEA 15

> NECK FINISH
Crimp

> FILL
50ml
100ml

> DIMENSION
H-83.7mm x W-63.5mm x W-30mm
H-109.5mm x W-84.7mm x W-40mm

F7010

> NECK SIZE
FEA 15

> NECK FINISH
Crimp

> FILL
100ml

> DIMENSION
H-90mm x W-88.2mm x D-46.2mm

F7013/7014

ECLAT

> NECK SIZE
FEA 15

> NECK FINISH
Crimp

> FILL
50ml
100ml

> DIMENSION
H-87.3mm x W-61.2mm x D-28.3mm
H-106.1mm x W-75.8mm x D-35.6mm



F7062/7036/7064

TERTIO

> NECK SIZE
FEA 15

> NECK FINISH
Crimp

> FILL
30ml
50ml
100ml

> DIMENSION
H-57.6mm x W-44.8mm x W-43.5mm
H-66.1mm x W-51.8mm x W-50.3mm
H-79.8mm x W-62.5mm x W-60.8mm



HD10729/13280/13281

JUNE

> NECK SIZE
FEA 15

> NECK FINISH
Crimp

> FILL
30ml
50ml
100ml

> DIMENSION
H-56.1mm x W-40.9mm x W-40.9mm
H-64.8mm x W-48.3mm x W-48.3mm
H-77.6mm x W-58.2mm x W-58.2mm



HD12524/12423/13282

MAX

> NECK SIZE
FEA 15

> NECK FINISH
Crimp

> FILL
30ml
50ml
100ml

> DIMENSION
H-71.3mm x W-50.4mm x W-26.7mm
H-84.7mm x W-60mm x W-28.4mm
H-103.3mm x W-75mm x W-31.5mm



HD13527/13630

ORCHID

> NECK SIZE
FEA 15

> NECK FINISH
Crimp

> FILL
50ml
100ml

> DIMENSION
H-77.7mm x W-50mm x W-39mm
H-98.7mm x W-59.6mm x W-46.4mm

HD11513/10270/10406

JUNE

> NECK SIZE
FEA 15

> NECK FINISH
Crimp

> FILL
30ml
50ml
100ml

> DIMENSION
H-85mm x W-33.6mm x W-33.6mm
H-103.5mm x W-38mm x W-38mm
H-136.5mm x W-44mm x W-44mm

ATOMIZERS

WHAT IS ATOMIZER?

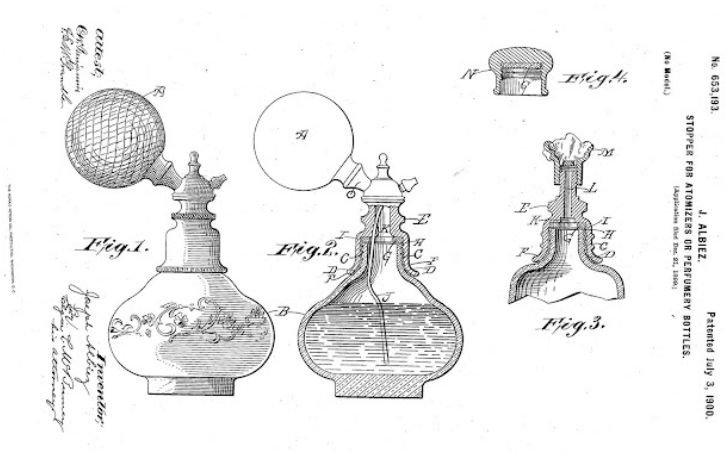

Classic fragrance atomizers use a squeeze bulb to store air that moves quickly over the feeder tube when squeezed. The bulb has two one-way valves located at either end. When the bulb is depressed, the valve leading into the tube is forced to open from the air pressure, while the valve leading to the outside is pulled closed. Once the bulb is released, the rubber inside returns to its original shape, closing the valve leading to the tube, and opening the valve to the outside so that air can refill the bulb.

Today, atomizers have a bottle with a tube that is connected to a nozzle. When the nozzle is engaged or pressed, it releases a small amount of liquid/spray through it. Atomizers mix oxygen and liquid perfume to create a fine mist, enabling you to release a small amount of perfume. When the airflow pulls some of the liquid out of the reservoir and mixes it with the airflow, the liquid breaks up into droplets suspended in the air, each of which has the same ratio of oil, alcohol, and water.

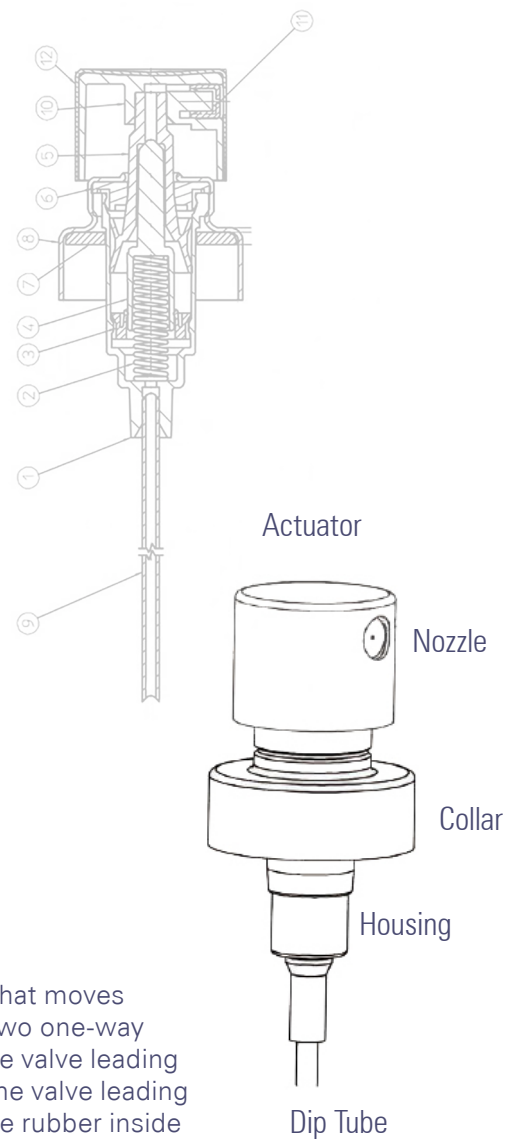

ATOMIZER KEY ATTRIBUTES



> CRIMP

Requires a crimping mechanism to attach to the crimp-neck bottle.



> CRIMPLESS

Typical crimping process is not required for this type of atomizer. Simply push the detached collar over the bottle neck to mount it onto a crimp-neck bottle.



> SCREW

This type of atomizer can be easily screwed onto a bottle by hand and is reusable. Screw type atomizers follow international neck finish standards like GPI/GCMI.

ATOMIZER

KEY ATTRIBUTES

> NECK SIZE

The FEA (Fédération Européenne des Aérosols) sets the standards for commercial perfumes bottles and closures. The single number indicates the outer diameter of the bottle neck at its widest point.

While the FEA 13 & FEA 15 are the mostly commonly used sizes, FEA 18, & FEA 20 among other custom sizes are also available, largely depending on the design of the glass bottle.

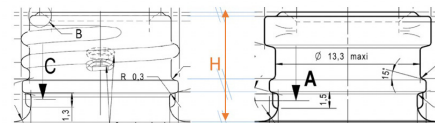

> COLOR & FINISH

While the plastic actuator and collar can be molded into any custom color, brands typically choose aluminum options in silver, gold, or black, with matte or shiny finishes, or create additional colors through the process of anodization.

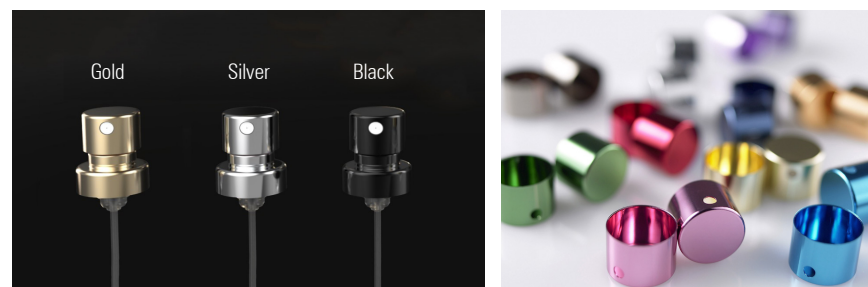

> DOSAGE

Each actuation dispenses a controlled amount of product. The most common dosages are:

- 0.07cc
- 0.10cc
- 0.13cc
- 0.15cc

> SPRAY ANGLE

30° & 45° are the most common angles for traditional fine fragrance

60° & 75° are commonly used with products that require wider coverage, like hair and body products.



STANDARD SERIES

FEATURES

- Alcohol / Water Based
- Consistent Atomization
- Smooth Actuation
- Short Housing
- Leak Proof



FB-LK

CRIMP TYPE

> NECK SIZE	> DOSAGE	> SPRAY ANGLE	> MATERIALS
13mm	0.07cc	30°	Shell: AL Piston: HDPE
15mm	0.10cc	45°	Nozzle: POM Spring: Stainles Steel
18mm	0.13cc	60°	Actuator: PP Housing: PP
20mm	0.15cc	75°	Gasket: PE Ball: Glass
			Crimp: AL Dip-Tube: PP



FB-SK

CRIMPLESS TYPE

> NECK SIZE	> DOSAGE	> SPRAY ANGLE	> MATERIALS
13mm	0.07cc	30°	Shell: AL Piston: HDPE
15mm	0.10cc	45°	Nozzle: POM Spring: Stainles Steel
18mm	0.13cc	60°	Actuator: PP Housing: PP
20mm	0.15cc	75°	Gasket: PE Ball: Glass
			Crimp: AL Dip-Tube: PP



FB-LY

SCREW TYPE

> NECK SIZE	> DOSAGE	> SPRAY ANGLE	MATERIALS
15mm	0.10cc	30°	Shell: AL Piston: HDPE
		45°	Nozzle: POM Spring: Stainles Steel
		60°	Actuator: PP Housing: PP
		75°	Gasket: PE Ball: Glass
			Crimp: AL Dip-Tube: PP

PREMIUM SERIES

FEATURES

- Alcohol / Water Based
- **No Droplets/Drift Under Slow Pressure**
- Superior, Soft & Smooth Actuation
- Extremely Short Housing
- No Crimping Line
- Leak Proof
- Flat Nozzle



DB-LK

CRIMP TYPE

> NECK SIZE	> DOSAGE	> SPRAY ANGLE	> MATERIALS
13mm	0.07cc	30° ± 15°	Shell: AL Piston: LDPE
15mm	0.13cc	60° ± 15°	Nozzle: POM Spring: Stainles Steel
			Actuator: PP Housing: PP
			Gasket: Sillicon Ball: Glass
			Crimp: AL Dip-Tube: PP

DB-SK

CRIMPLESS TYPE

> NECK SIZE	> DOSAGE	> SPRAY ANGLE	> MATERIALS
13mm	0.10cc	30° ± 15°	Shell: AL Piston: LDPE
15mm	0.13cc	60° ± 15°	Nozzle: POM Spring: Stainles Steel
			Actuator: PP Housing: PP
			Gasket: Sillicon Ball: Glass
			Crimp: AL Dip-Tube: PP

DB-LY

SCREW TYPE

> NECK SIZE	> DOSAGE	> SPRAY ANGLE	MATERIALS
15mm	0.10cc	30° ± 15°	Shell: AL Piston: LDPE
		60° ± 15°	Nozzle: POM Spring: Stainles Steel
			Actuator: PP Housing: PP
			Gasket: Sillicon Ball: Glass
			Crimp: AL Dip-Tube: PP

SAMPLE SIZE



FEATURES

- Alcohol / Water Based
- Consistent Atomization
- Smooth Actuation
- Leak Proof
- 1.5ml and 2ml

JVB

CRIMP TYPE

> NECK SIZE
9mm

> DOSAGE
0.03cc

> SPRAY ANGLE
30° ± 15°

> MATERIALS
Nozzle: POM
Actuator: PP
Piston: LDPE
Spring: Stainles Steel
Housing: PP
Ball: Glass
Dip-Tube: PP



SOLID FRAGRANCE



CP033

RINGE HINGE COMPACT

> FILL
2.5g

> MATERIAL
Zamac



CP024

STONEBROOK COMPACT

> FILL
2.2g

> MATERIAL
Zamac



CP007

ZAMAC SWIVEL COMPACT

> FILL
3.2g

> MATERIAL
Zamac



CP018

ZAMAC CHOP BOX - FLIP

> FILL
2.2g
5.1g

> MATERIAL
Zamac



CP017

ZAMAC CHOP BOX - SLIDE

> FILL
1.7g

> MATERIAL
Zamac



TIN01

SLIDING TIN COMPACT

> FILL
Various sizes and
fill weight available

> MATERIAL
Tin



CP022

HEART COMPACT

> FILL
3.0g

> MATERIAL
Zamac



CP023

PENDANT COMPACT

> FILL
1.8g

> MATERIAL
Zamac



CP040

ZAMAC BALL COMPACT

> FILL
3.0g

> MATERIAL
Zamac



CP099

OVAL COMPACT

> FILL
4.8g

> MATERIAL
Zamac



CP149

ZAMAC BALL COMPACT

> FILL
3.0g

> MATERIAL
Zamac



RG003

ZAMAC TRIANGLE RING

> FILL
0.3g

> MATERIAL
Zamac



RG018B

ZAMAC FLOWER RING

> FILL
0.84g

> MATERIAL
Zamac



NEW
FORMATS



CODE TBD

FLOW THROUGH SPONGE TIP (& PURE GLASS CHUBBY)

- > FORMULAR PAIRING
EDT/EDC
- > TOOLING
Pilot
- > FILL
15ml
- > MATERIAL
Capillary Tubule

A146/018/188

FLOW THROUGH BRUSH - MINI, REGULAR & SILM

- > FORMULAR PAIRING
Powder
- > TOOLING
Production
- > FILL
5.3ml
8ml
11.2ml
- > MATERIAL
Cap, Collar & Base: ABS/SAN
Tube: ABS/SAN
Head & Receiver: PP
Magnet: Neodymium
Pot: PCTG
Ring: NBR
Hair: Synthetic
Headle & Pipe: Aluminum
Washer: Steel

A017

FLOW THROUGH POT PUFF - MINI & LARGE

- > FORMULAR PAIRING
Powder
- > TOOLING
Production
- > FILL
14ml
36,3ml
- > MATERIAL
Sponge:SBR
Mirror: Glass
Gasket:TPE
Cap/Innerdial: ABS/PCR
Bottle/Outerdial:ABS/PCR
Ring:Silicone



YL610/6093

HALO TOTTLE - ROUND & SQUARE

- > FORMULAR PAIRING
Gel
Lotion
- > TOOLING
Production
- > FILL
13.4ml (Round)
8,8ml (Square)
- > MATERIAL
Cap:



JS-RB-5

AIRLESS CRAYON

- > FORMULAR PAIRING
Oil
EDP
- > TOOLING
Production
- > FILL
5ml
- > MATERIAL
Cap & Bottle: PP
Actuator: PP
Stem: PP
Piston: PP
Pump: PP
Seal Ring: PE
Spring: TPE



YL6250

CHUBBY TOTTLE PEN

- > FORMULAR PAIRING
Gel
- > TOOLING
Production
- > FILL
10ml
- > MATERIAL
Cap: PP
Plug: PCTG
Insert: PETG
Base: ABS/SAN
Bottle: Surlyn



YL6353

MISFIT TOTTLE

- > FORMULAR PAIRING
Gel
Lotion
- > TOOLING
Production
- > FILL
30ml
- > MATERIAL
Cap: PP
Tip: PP
Tottle: PP/LDPE
Overshell: PP/AL



JS-RB-5

DUO SETTING STICK

- > FORMULAR PAIRING
EDT/EDC
Solid
- > TOOLING
Production
- > FILL
15ml
7g
- > MATERIAL
Stick Cap: ABS/SAN
Sleeve Shell: AL
Sleeve: PP
Cup: POK
Stick Base: PCTG
Body: PCTG
Pump Cap: PP
Nozzle: PP
Collar: PP



YL6029

CHUBBY LIP PEN (AIRTIGHT)

- > FORMULAR PAIRING
Solid
- > TOOLING
Production
- > FILL
XX
- > MATERIAL
Cap & Collar: PCR ABS
Cup: POM
O-Ring: Rubber
Screw: PCR PP
Handle: PCR ABS
Weight: Stainless Steel



YL6352

AURA TOTTLE

> FORMULAR PAIRING
Gel
Lotion

> TOOLING
Pilot

> FILL
15ml

> MATERIAL
Cap: PP
Applicator: TPR + PP
Collar: PP
Tottle: LDPE



YL6027

MINI FOUNDATION STICK

> FORMULAR PAIRING
Solid

> TOOLING
Production

> FILL
3.4g

> MATERIAL
Cap, Collar & Base:ABS/SAN
Sleeve Cap & Sleeve:PCR PP
Screw Cup & Screw Base:POM



C6005

ALUMINUM CHUBBY STICK

> FORMULAR PAIRING
Solid

> TOOLING
Production

> FILL
5g

> MATERIAL
Inner Cap & Base: PP
Collar: PP
Screw: POM
Cup: POM
Cap & Base: Aluminum
Weight: Stainless Steel



YL6384

2-IN-1 BLUSH STICK

- > FORMULAR PAIRING
Solid
- > TOOLING
Production
- > FILL
5ml
- > MATERIAL
Cap/Base:ABS/SAN/PCR
Screw Base/Cup:POM
Jar Liner/Sleeve Cap/Sleeve:PP/PCR
Jar Seal:PE
Jar:PMMA



A370

REFILLABLE SERUM STICK

- > FORMULAR PAIRING
Solid
- > TOOLING
Pilot
- > FILL
30g
- > MATERIAL
Base: PP
Cup Bottom Cap: PP
Fill Cap: PP
Cup: PP
Cap: PP
Overshell (Option): AL



HR1006B3

PURE SHAKER BOTTLE

- > FORMULAR PAIRING
Encapsulated Beads
- > TOOLING
Production
- > FILL
20g
- > MATERIAL
Cap: PP
Jar: PCTG
Liner: FT-217
Tip: PP
Induction Seal: PE+AL



RS160/182/220

ROLLER GLASS VIAL

> FORMULAR PAIRING
Oil
EDT/EDC

> TOOLING
Production

> FILL
5ml
10ml
15ml
20ml
25ml

> MATERIAL
Vial: Glass
Ball: Glass or Stainless Steel
Cap: PP
Overcap (optional): AL



E0160

TUBE GLASS DROPPER

> FORMULAR PAIRING
Oil
EDT/EDC

> TOOLING
Production

> FILL
3ml
5ml
10ml

> MATERIAL
Vial: Glass
Collar: PP & AL
Bulb: NBR



A280

PURE CHUBBY GLASS DROPPER

> FORMULAR PAIRING
Oil
EDT/EDC

> TOOLING
Production

> FILL
15ml

> MATERIAL
Cap: Aluminum
Stem: POK
Wiper: LDPE/TPE
Bottle: Glass
Applicator Options: Metal, Ceramic, Flocked



1061BF

PUSH AIRLESS BOTTLE

> FORMULAR PAIRING
Oil
Gel
EDT/EDC

> TOOLING
Production

> FILL
6.6ml

> MATERIAL
Applicator: Brush, TPE Spatula, & Roller Balls



1033B

TWIST AIRLESS BOTTLE

> FORMULAR PAIRING
Oil
Gel
EDT/EDC

> TOOLING
Production

> FILL
10ml

> MATERIAL
Applicator: Brush, TPE Spatula, & Roller Balls



OFFICE LOCATIONS

LOS ANGELES

2800 28th Street, Suite 240
Santa Monica CA 90405
Tel: 310.260.7680
E: info@hctusa.com

NEW YORK

600 5th Avenue, 15th Floor
New York, NY 10020
Tel: 212.586.0303
E: info@hctusa.com

NEW JERSEY

46 East Main Street, Suite 202
Somerville, NJ 08876
Tel: 908.203.8610
E: hct@hctusa.com

PARIS

3 rue la Boétie,
75008 Paris, France
Tel: +33 (0)1 71 22 40 00
E: info@hctgroup.com

HONG KONG

23rd Floor, West Exchange Tower,
322 Des Voeux Road Central
Sheung Wan, Hong Kong
Tel: 852.3622.5090
E: info@hctasia.com

SHANGHAI

Room 903, Tower C
No. 518 Shen Chang Rd.
Minhang District, Shanghai,
201107, China
Tel: +86 21 6228 2866
E: info@hctgroup.com

SEOUL

30 FI POSCO Tower Songdo
165 Convensia Daero
Yeonsu-gu, Incheon
21998 Republic of Korea
Tel: +82 10 3439 3225
E: info@hctgroup.com

LONDON

Second Floor Pepys Court
84086 The Chase
London, UK SW4 0NF
Tel: +44 (0) 20 7720 8206
E: info@hctgroup.com

HCT
by kdc/one

LOS ANGELES | NEW YORK | NEW JERSEY | LONDON | PARIS | HONG KONG | SHANGHAI | SEOUL

hctgroup.com | info@hctgroup.com | [@hct.group](https://www.instagram.com/hct.group)